

WINCH ASSEMBLY DRAWING 45SPS12-CAD, 45SPS24-CAD, 45SPA12-CAD, 45SPA24-CAD

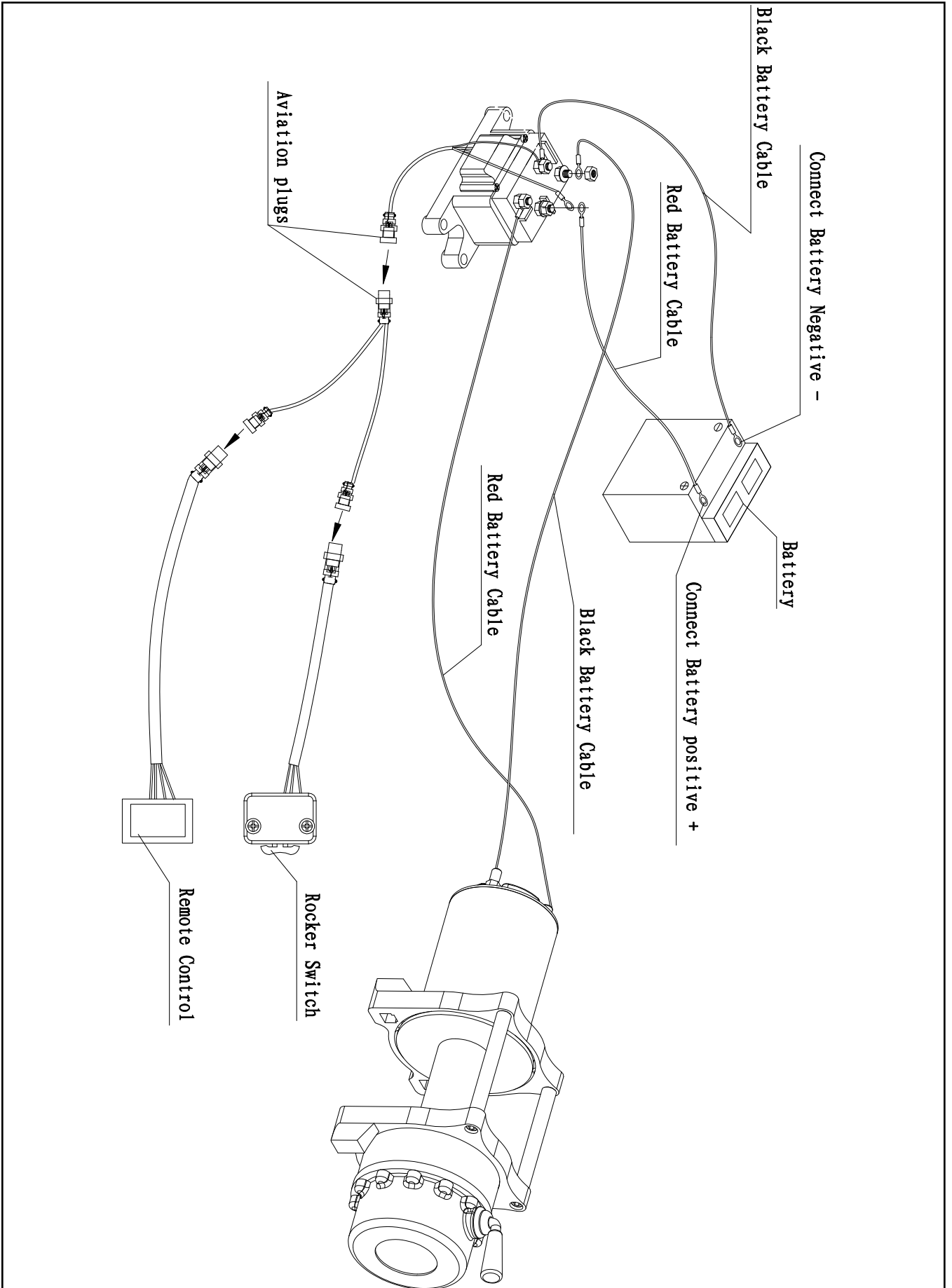

WINCH ASSEMBLY DRAWING 45SPS12-CAD, 45SPS24-CAD, 45SPA12-CAD, 45SPA24-CAD

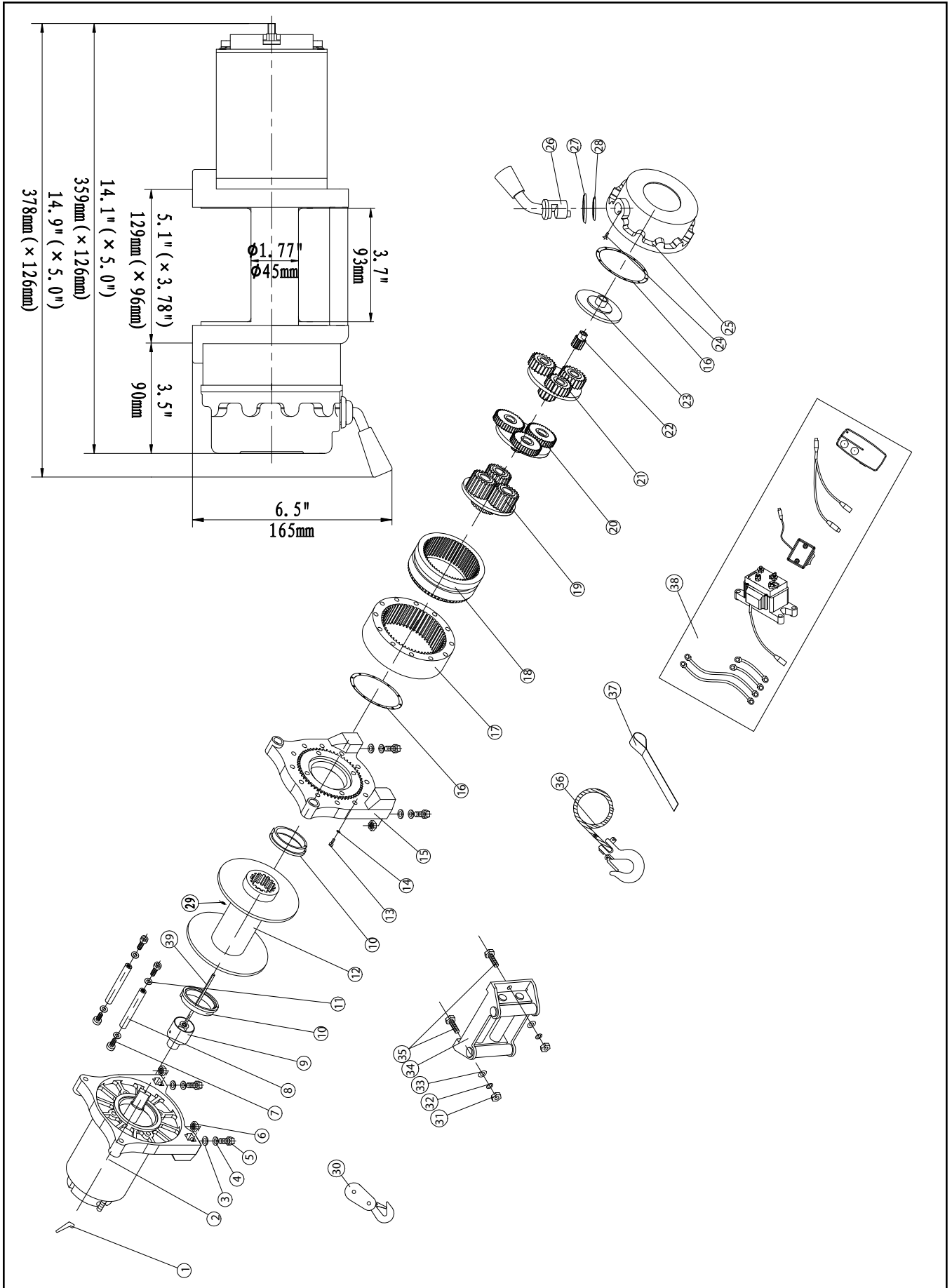

WINCH PARTS LIST (45SPS12-CAD, 45SPS24-CAD, 45SPA12-CAD, 45SPA24-CAD)

#	Part Number	Description	Qty.
1	X450001	Terminal Protector	2
2	X450100	Motor Assembly	1
3	X450002	Thick Flat Washer Ø8	4
4	X450003	Locking Washer Ø8	4
5	X450004	Cap Screw M8 x 25	4
6	X450005	Locknut M8	4
7	X450006	Cap Screw M6 x 20	4
8	X450007	Tie Bar	2
9	X450200	Break/Shaft Assembly	1
10	X450008	Bushing-Drum	2
11	X450009	Locking Washer Ø6	4
12	X450300	Drum Assembly	1
13	X450010	Screw M5 x50	8
14	X450011	Locking Washer Ø5	8
15	X450012	End Bearing	1
16	X450013	Gasket	2
17	X450014	Gear-Ring	1
18	X450015	Gear-Ring (Inner)	1
19	X450400	Gear Carrier Assembly(Output)	1
20	X450500	Gear Carrier Assembly(Intermediate)	1
21	X450600	Gear Carrier Assembly(Input)	1
22	X450016	Gear-Input Sun	1
23	X450017	Trust Washer	1
24	X450018	Gear-Housing	1
25	X450019	Clutch Screw	1
26	X450020	Clutch Handle	1
27	X450021	Clutch Cover	1
28	X450022	Ring Seals	1
29	X450023	Screw M8 x 8	1
30	X450700	Snatch Block	1
31	X450024	Hex Flange Nut M8	2
32	X450003	Locking Washer Ø8	2
33	X450002	Thick Flat Washer Ø8	2
34	X450800	Roller Fairlead	1
35	X450025	Cap Screw M8 x 20	2
36	X450900	Cable Assembly	1

#	Part Number	Description	Qty.
37	X450026	Strap	1
38	X450027	Control Section	1
39	X450028	Six Angle Bar	1